

FOR LEASE

Neighbourhood Centre



parkgreen.co.nz



Artist impression

Overview

Join the brand new and exciting retail development at the picturesque Park Green, Hingaia - available from late 2024.

The Park Green Neighbourhood Centre is in the heart of Hingaia community which is expected to service a population of over 13,000 in the future.

The Mangapikopiko School which opened in 2022 is right across the road with easy access to nearby coastal walkways, parks and cycle networks.

With modern housing and retirement living being developed along with the road access to Karaka Lakes – the Park Green Neighbourhood centre is positioned to be a community centric ‘go to place’ for eating, shopping and essential needs.



Artist impression

Key Features



OVER 80 CARPARKS ONSITE

Plenty of shared car parking onsite with over 80 spaces.

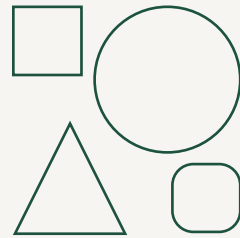

RANGE OF TENANCIES AVAILABLE

Range of tenancies available for café, general store, speciality retail, grab-n-go, etc. Sizes ranging from 69m² – 187m².

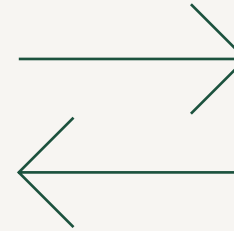

CONVENIENT CUSTOMER ACCESS

Two key entry and exit access points for customers.



AFFLUENT RESIDENTS & HOUSES

Captive customer base of affluent, modern and sought-after homes built by NZ's most loved builders such as GJ Gardner, Fletcher Residential, Signature, Stonewood, Sentinel homes and many more.

Retail Site Plan & Lease Summary

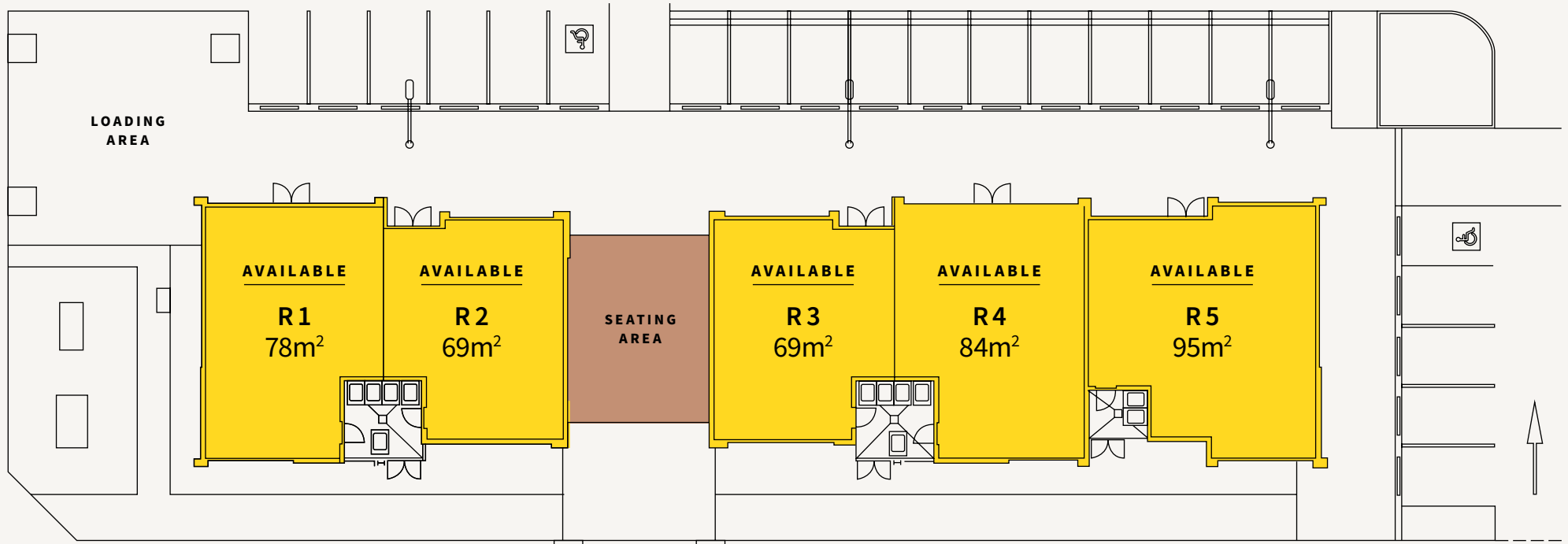

LEASE SUMMARY

	R1	R2	R3	R4	R5
AREA	78m ²	69m ²	69m ²	84m ²	95m ²
RENTAL	TBA	TBA	TBA	TBA	TBA
OUTGOINGS	TBC	TBC	TBC	TBC	TBC
TARGET COMPLETION	Q4 2024	Q4 2024	Q4 2024	Q4 2024	Q4 2024

Plans indicative only.

Café Site Plan & Lease Summary

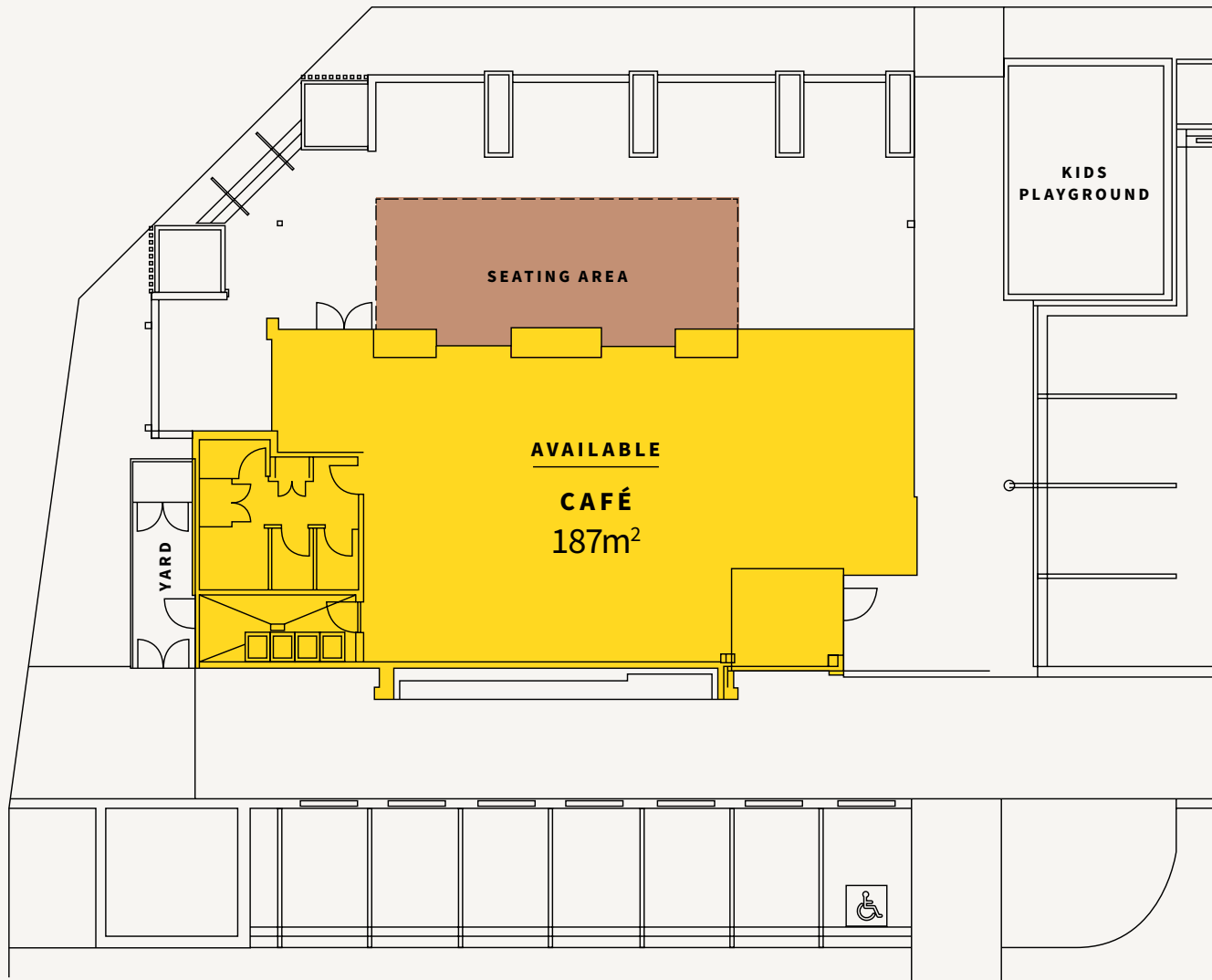

LEASE SUMMARY

	CAFÉ
AREA	187m ²
RENTAL	TBA
OUTGOINGS	TBC
TARGET COMPLETION	Q4 2024

Development Site Plan



Location Map

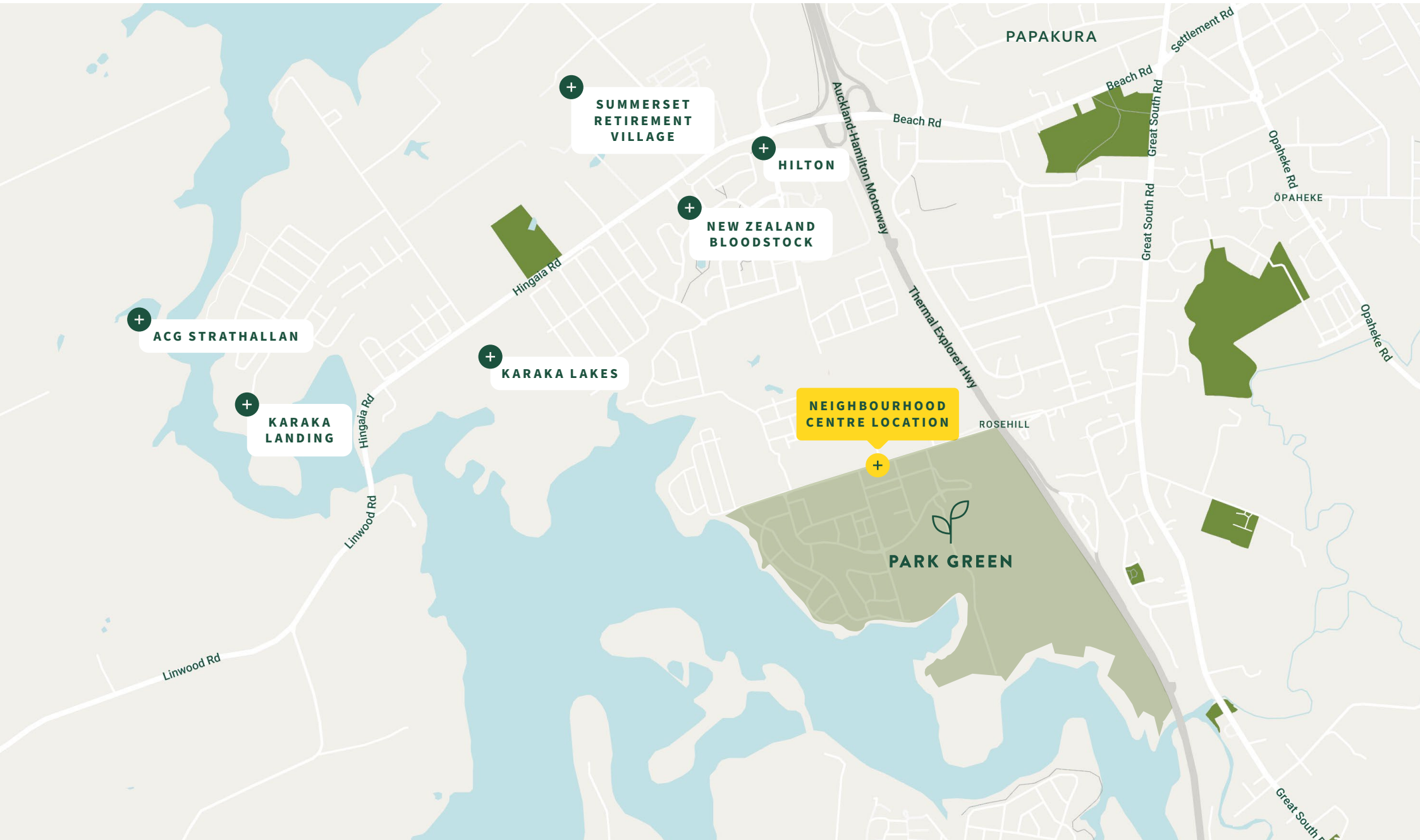

Site Location

 **PARK GREEN** NEIGHBOURHOOD CENTRE FOR LEASE



**NEIGHBOURHOOD
CENTRE LOCATION**
+

Luke Sullivan
P 09 622 3800
M 021 557 140
leasing@parkgreen.co.nz

Nevil Bulsari
P 09 622 3800
M 021 848 191
leasing@parkgreen.co.nz

parkgreen.co.nz

 **HUGH GREEN
GROUP**

 **7 YEARS
EST. 1953**